

01 Wheelchair Adaptable Unit - M4(3)(a)
Typical Resi Layout

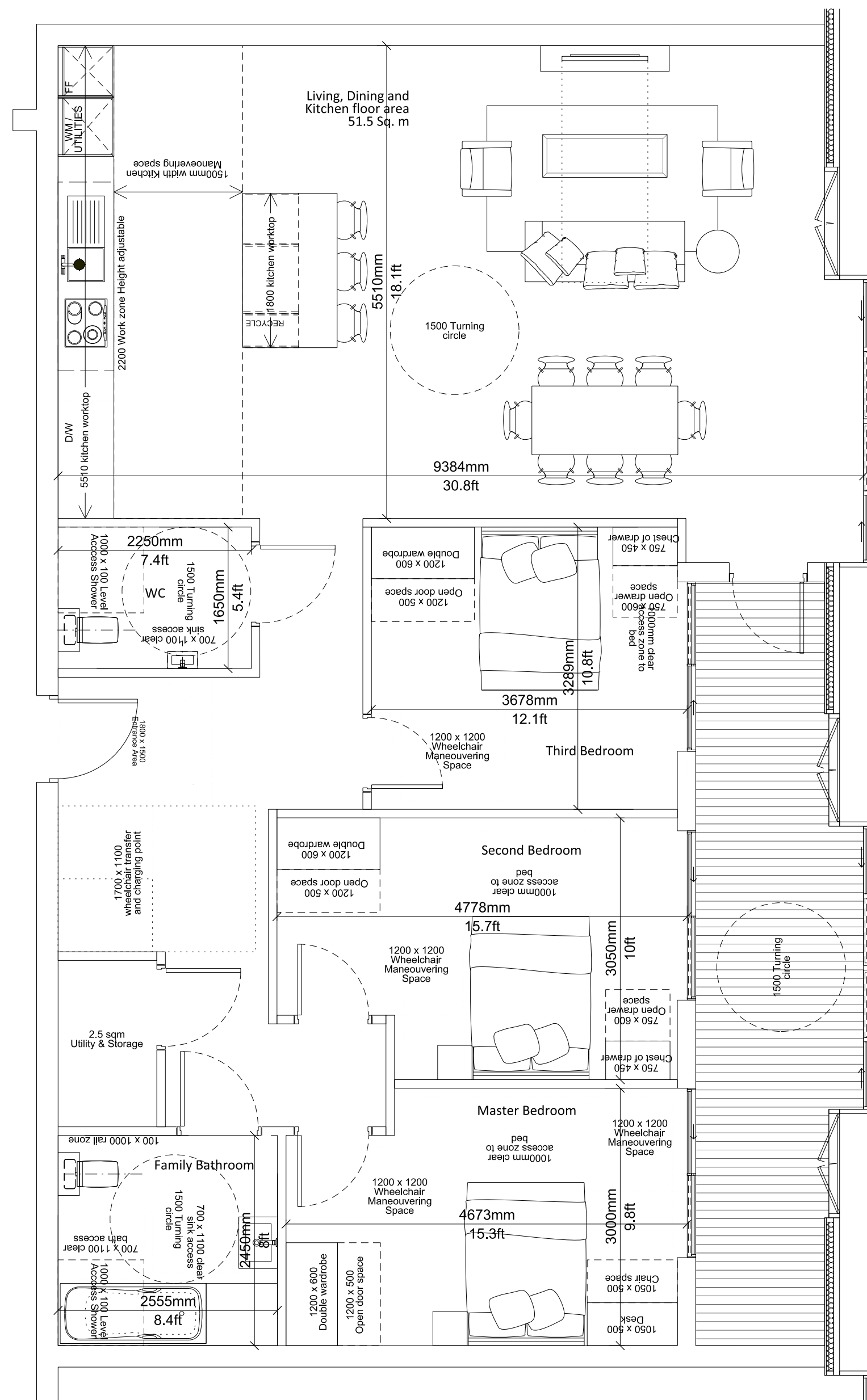

02 Wheelchair Accessible Unit - M4(3)(b)
Typical Resi Layout

This drawing is copyright
Do not scale off dimensions.
All dimensions to be checked on site by contractor.
Contractor to report any dimensional discrepancies,
errors or omissions prior to commencing on site.



NOTE:

NORTH

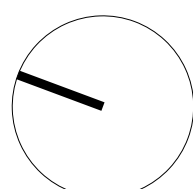

Rev	Date	Description
-	15/06/2018	Full Planning Application
A	11/01/2019	GLA Call-In Amendments

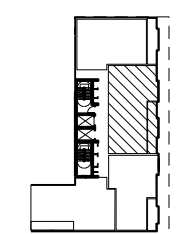

Level 00 Mezz

Project Title	Kensington Forum Hotel Kensington, London
Status	PLANNING

Drawing Title			
Typical Wheelchair Accessible Residential Layouts			
Job No 10106		Scale 1:50@ A1	Date JAN 2019
Drawing No 10106-A-DRG-Z2-F200-2002-PL			Revision A

simpsonhaugh

MANCHESTER
Riverside, 4 Commercial St
Manchester M15 4EQ
+44 (0)161 835 2345
www.simpsonhaugh.com

LONDON
5-8 Roberts Place
London EC1R 9BB
+44 (0)20 7549 4000
mail@simpsonhaugh.com